

Sensory Room Maps – Clifton Campus Library

Our brand new Sensory Maps are a tool designed with inclusivity in mind. The maps will help you choose the perfect place to work, study, or relax.

Using sensory icons and a key describing what to expect in that area, the maps highlight noise levels, lighting, smells and activity zones across all library floors, so that you can quickly find the environment that suits your needs—whether that’s a group or collaborative study area, silent study space, individual quiet study space or a dedicated space to regulate.

Clifton Library Level 0

Clifton Library Level 0

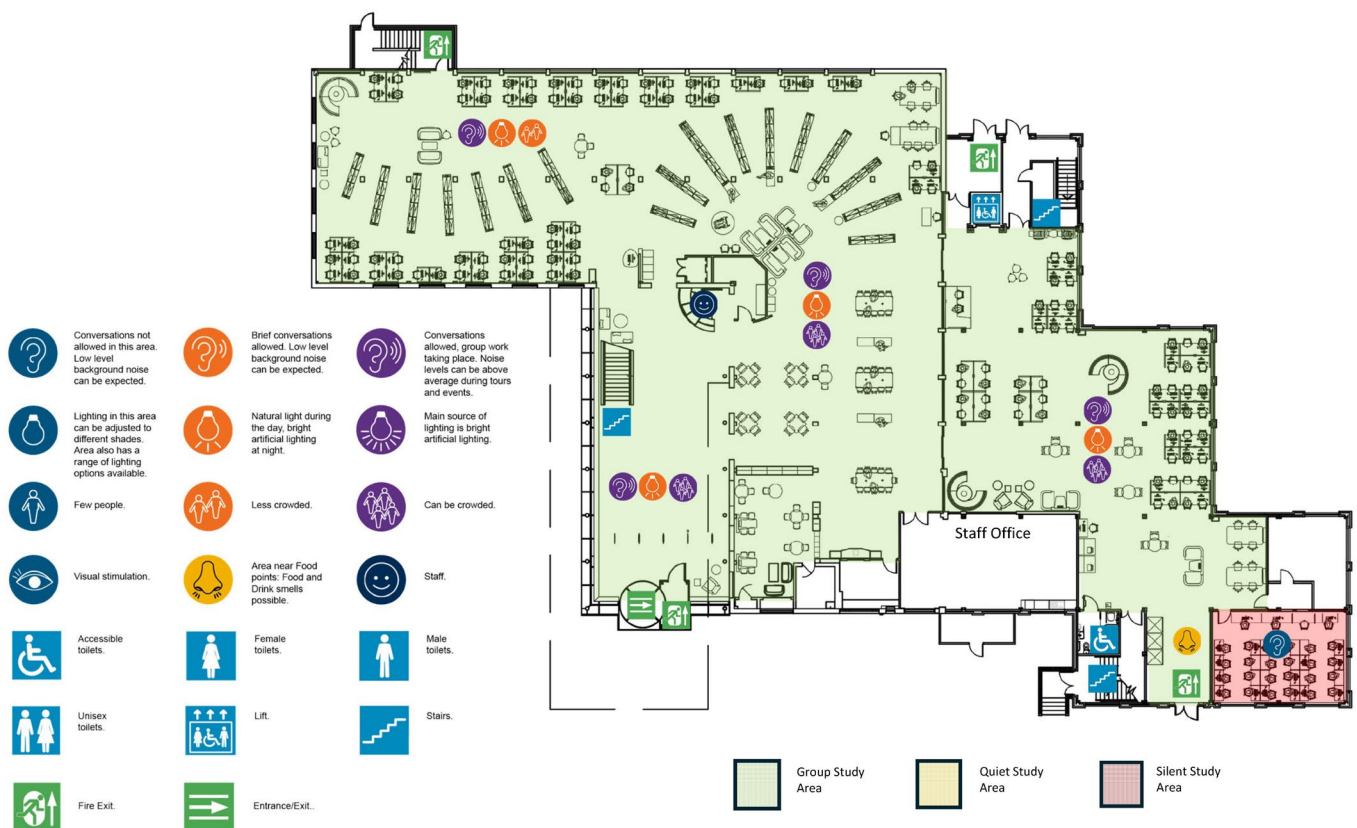

Clifton Library Level 1

